

HIGH CAPACITY LIGHT WEIGHT BLOCKS

LIGHT WEIGHT TILT-UP BLOCKS

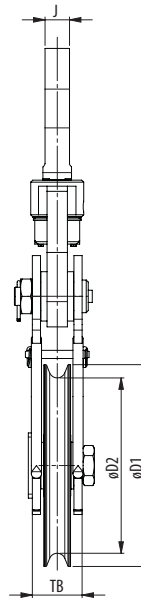
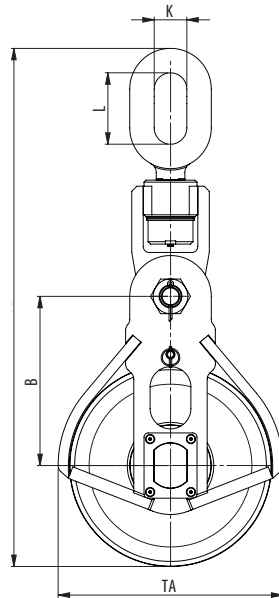
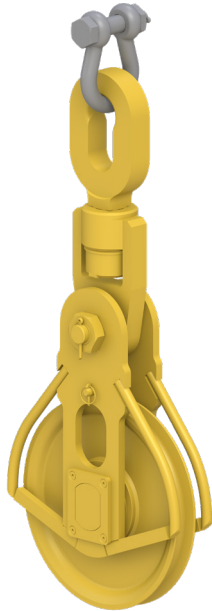

- Hook
- Clevis
- Tailboard
- Oblong eye

Model Nr.	WLL (Mtons)	For wire ød (mm)	Dimensions (mm)									Weight (kg)
			øD1	øD2	B	J	K	L	TA	TB	TL	
HCLW 240.28.1.25.O	25	28	300	240	260	50	75	150	356	102	945	80
HCLW 290.32.1.25.O	25	32	350	290	285	50	75	150	406	102	995	90
HCLW 355.32.1.27.O	27	32	420	355	375	60	80	175	476	112	1193	114
HCLW 355.36.1.27.O	27	36	420	355	375	60	80	175	476	122	1193	114
HCLW 355.36.1.32.O	32	36	420	355	375	60	80	175	476	122	1193	120
HCLW 430.32.1.27.O	27	32	495	430	415	60	80	175	551	112	1271	125
HCLW 430.32.1.32.O	32	32	495	430	415	60	80	175	551	112	1271	137
HCLW 430.38.1.32.O	32	38	495	430	415	60	80	175	551	122	1271	137
HCLW 430.38.1.40.O	40	38	495	430	415	65	90	200	551	122	1311	170
HCLW 520.38.1.55.O	55	38	595	430	485	70	100	225	651	132	1536	200
HCLW 520.44.1.55.O	55	44	595	520	485	70	100	225	651	132	1536	220
HCLW 520.52.1.55.O	55	52	595	520	485	70	100	225	651	132	1536	220
HCLW 630.58.1.81.O	81	58	710	630	575	80	110	250	776	152	1833	420
HCLW 760.70.1.100.O	100	70	900	760	735	95	125	275	980	200	2185	620
HCLW 760.76.1.125.O	125	76	900	760	735	100	125	275	980	200	2185	650

Minimum Ultimate Strength = 4 x WLL

WLL= Working Load Limit on head fitting.

- The dimensions in this table are indicative only. A drawing will always be submitted prior to production and will be the leading document when discussing dimensions.
- Blocks shown here are standard models; inquiries for custom versions are welcome.
- Refer to wire rope manufacturers D/d ratio guideline.



SEE OUR WARNING & SAFETY INFORMATION